

CL40 DALI

Up to 40W, Switchable

350/230mA, 500/350mA & 1050/700mA

CoolLED drivers provide a high performance solution for powering high-brightness LEDs from a mains supply

These power factor corrected, class II drivers (B/C style) and class I drivers (OF style) have fully isolated, SELV output delivering up to 40W of power

Full DALI dimming support from 100% to 1% output current and the ability to turn completely off.

Individual and Group Control - Ability to control individual LED luminaires and simultaneous control of all or specified DALI groups.

Two Levels of maximum output current selectable.

Hot Plug - Also benefits from output Hot-plug protection

OF coming soon

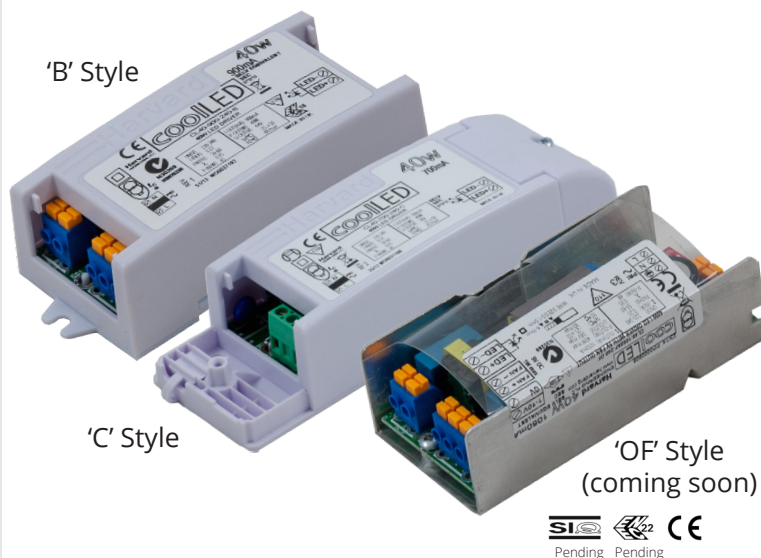

SI Pending ENEC Pending CE

Key Facts

- 220V - 240V Input voltage
- DALI terminals on the mains side
- Power factor corrected (>0.95)
- Self resetting thermal trip
- Up to 87% efficient
- Surge protection up to 4kV
- SELV isolation (3kV)
- B (& OF) Style products have push terminals
- C Style have cable clamps
- Open and short-circuit protected
- Self-resetting over temperature trip
- Full DALI control
- Dip switch to select one of two current levels

Wiring diagram

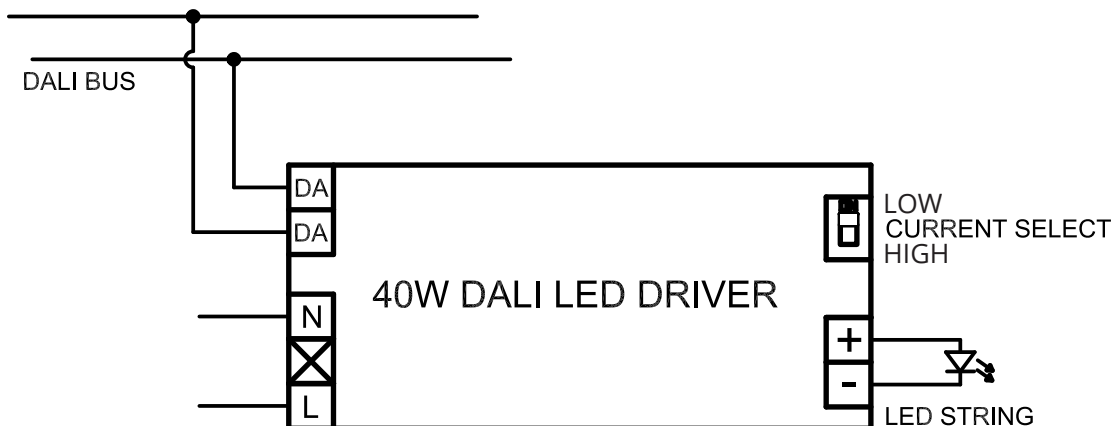

*All information is subject to change at our discretion

** For custom variants please consult a sales representative

CL

CoolLED LED Drivers



CoolLED

Technical specification

Mains input voltage	220 to 240V ac RMS Nominal
Mains frequency	50 - 60Hz
Mains surge protection	4kV common-mode 2kV differential
Input-output isolation	Reinforced to 3kV
Humidity	95% max non-condensing
Ambient temperature range	-25 °C to 50 °C
Maximum Tc temperature	85 °C
Input power when output is off	<0.4W
Dimming range	100% - 1%
Terminal blocks	C Style Rising clamp 5mm Pitch, B and OF Style Push terminal
Enclosure	White polycarbonate UL94-V0 rated
Wire size	0.5mm to 1.5mm ²

Variants

Part number	Current	LED String Voltage	Output power range (undimmed)	Power factor at full load	Efficiency at full load
CL40-350S2D-240-B/C/OF*	230 & 350mA (±5%)	9V to 58V	230mA : 2.07 - 13W 350mA : 3 - 20.3W	>0.95	80%
CL40-500S2D-240-B/C/OF*	350 & 500mA (±5%)	9V to 58V	350mA : 3 - 20.3W 500mA : 4.5 - 29W	>0.95	83%
CL40-1050S2D-240-B/C/OF*	700 & 1050mA (±5%)	9V to 38V / 57V	700mA : 6.3 - 40W 1050mA : 9.45 - 40W	>0.95	85%

* OF Coming soon

*All information is subject to change at our discretion

** For custom variants please consult a sales representative

CL

CoolLED LED Drivers



CoolLED

Dimensions

B Style

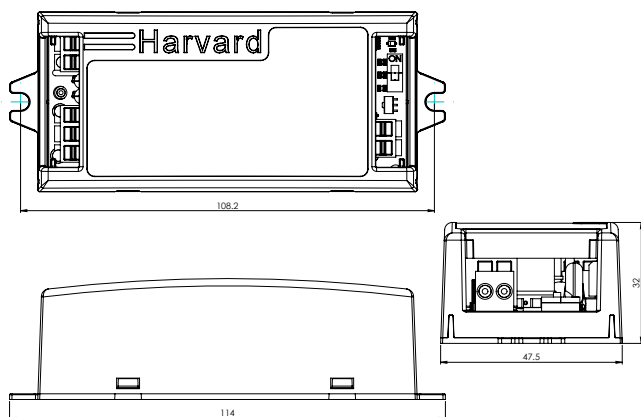

C Style

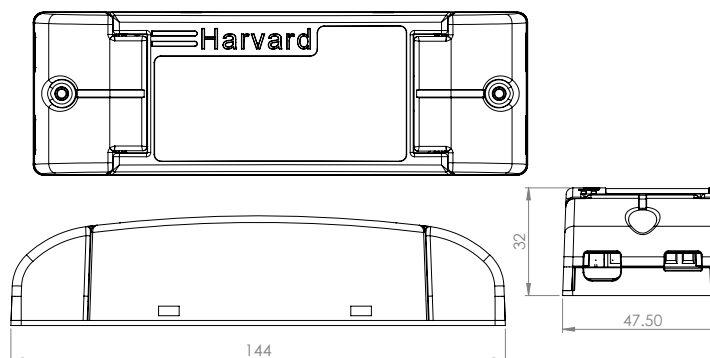

OF Style - Coming soon

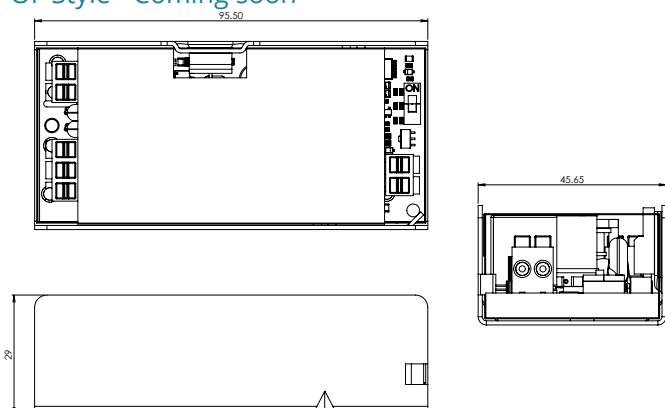

Case Style	Dimensions	Weight	Box Quantity
B - Integral	114mm x 47.5mm x 32mm	133g	50
C - Remote	144mm x 47.5mm x 32mm	158g	50
OF - Open Frame Variant	95.50mm x 45.65mm x 29mm	125g	50

Tolerance: + or - 0.3mm

Compliance

Approval	Standards
ENEC	EN 61347-2-13, EN 61000-3-3, EN 6154, EN 62384, EN 55015:2006+A2:2009, DALI Standard & EN62386-207

*All information is subject to change at our discretion

** For custom variants please consult a sales representative